

# SCION NPD Spare Parts

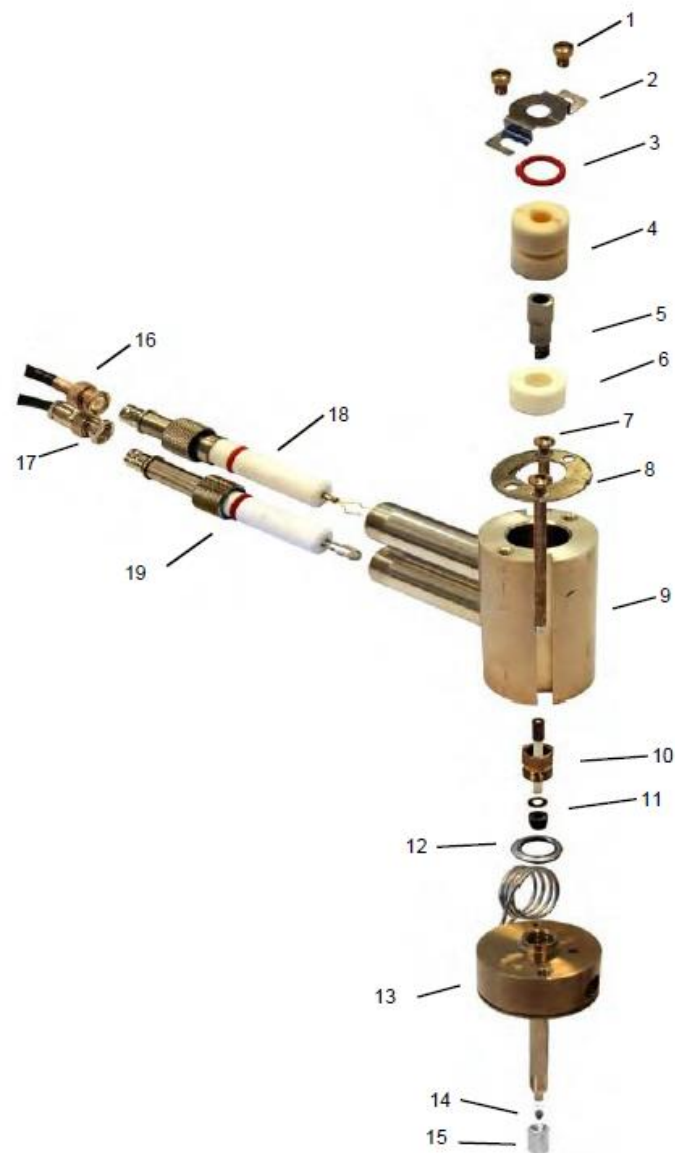

#	Description	P/N
1	Screws, 8-32x1/4"	1214200804
2	NPD Top Clamp	800022900
3	O-Ring,0.487"x0.103"	2740928202
4	Upper Insulator	2100003100
5	Collector Tube	390607900
6	Ceramic Insulator	210003200
7	TowerScrews,8-32x3"	391866301
8	Tower Top Plate	3400073100
9	Detector Tower Body	390607700
10	Flame Tip, 0.02" standard tip	200193800
11	Flame Tip Ferrule	
	Vespel 100%, up to 350°C	CR212200
	40%G/60%V, up to 400°C	CR213200
	Graphite, up to 450°C	CR211200
12	Aluminium Crunch Washer	1500334701
13	Detector Base	392547501
14	Column Ferrule	See Ferrules
15	Column Nut	
	0.9mm Capillary, brass	394955100
	1.6mm for 1/16", brass	CP742351
	High Temp, stainless-steel	CP743117
16	Signal Cable	391783000
17	NPD Bead Cable	392548801
18	NPD Signal Probe	390607600
19	NPD Bead Conditioned & Tested	390607401
	Probe O-Ring, 0.505 OD	390596004
	Flow Tube, 1/8" OD	200196700
	NPD TestMix	8200504804